

Emmanuel's

Emphasis: Weekly Edition

Issue #: 3-160821

Preceding Sunday, August 21, 2016

Emmanuel Lutheran Church

1036 W A Street, Moscow, ID 83843 - Phone: 208.882.3915 - Fax: 208.882.3917
emmanuelmoscowid@gmail.com - www.emmanuelmoscow.org
Church Office Hours: Monday through Friday, 8:30 AM - 4 PM (unless otherwise noted.)

Emmanuel Lutheran Church Women (ELCW)

Emmanuel Lutheran Church Women (ELCW) encompass a huge part of our ministries here at Emmanuel. This group of strong Christian women have a continuing emphasis on Evangelical Outreach, Global Mission, World Hunger, Bible Study, Justice, Worship, Prayer, and Christmas for Kids. The group has Standing Committees for Emmanuel Weddings, Funeral Receptions, and Church Women United.

DID YOU KNOW?

You belong to a special group here at Emmanuel! ALL women of Emmanuel Lutheran Church are members and are invited to ALL meetings and programs of the ELCW!

WHAT IS THE ELCW YOU ASK?

This stands for Emmanuel Lutheran Church Women, which is a part of Women of the Evangelical Lutheran Church in America!

WHAT IS ELCW'S PURPOSE YOU ASK?

A community of women, created in the image of God, called to discipleship in Jesus Christ, and empowered by the Holy Spirit. We commit ourselves to grow in faith, affirm our gifts, support one another in our callings, engage in ministry and action, and promote healing and wholeness in the church, the society and the world.

HOW DO I GET INVOLVED YOU ASK?

Join a Circle! It's easy! Just jump right in! All circles meet once or twice a month at varying times and locations. Stop by the Church Office and pick up an ELCW Directory which gives information about the circles.

ELCW 2016 OFFICERS:

President: Jan Martin - Vice President: Charlene Olsson
Secretary: Janice Johnson - Treasurer: Verla Olson Claus

September Circle Start-Up!



MARY Circle usually meets the first Monday of the month. The group will meet on Monday, September 12, 2016 (the Monday following Labor Day) at 1:30 PM, at Good Samaritan Village Community Room. Questions? Call **Shelley Dale** at 208.882.9555 or email: sdale@turbonet.com



LEAH Circle usually meets the first Tuesday of the month for devotions and a potluck lunch. All women at Emmanuel are warmly invited. The group will meet on Tuesday, September 6, 2016 at 11:30 AM. Location and Bible Study Leader TBD. Questions? **Jeanette Johnston** 208.892.9549, or **Charlene Olsson** 208.882.1028

Join ELCW **PIECEMAKERS** every 2nd and 4th Wednesday!

Help us quilt! Bring a friend! Have some lunch!

We usually meet on the 2nd and 4th Wednesdays. Join us on **August 24 at 9 AM**, to help tie quilts, then share a potluck lunch with us at noon. Contact **Gretchen Isakson** at gretchenisakson@yahoo.com or 882.7289.

"Whatever your hands find to do, do it with all your might." Ecclesiastes 9:10



Ed Opps

Sunday's Scripture Segments

Scripture readings for the
14th Sunday after Pentecost
August 21, 2016, are:

Isaiah 58:9b-14

The Lord promises those who have returned from exile that where justice and mercy prevail, the ruins will be rebuilt and light will rise in the darkness. It is a day for new beginnings.

Hebrews 12:18-29

Using images of Moses from the Old Testament, the writer presents a striking vision of the new covenant of God made possible in Christ. There is no longer fear; only awe in the new promise in Christ into which we are invited.

Luke 13:10-17

Jesus heals a woman on the sabbath, offering her a new beginning for her life. When challenged by a narrow reading of the sabbath command, Jesus responds by expanding "sabbath work" to include setting people free from bondage.

Preaching and Presiding:

Pastor Dave Daugs

i.e. Christian Education Opportunities

Adult Opportunities in Sunday School

Prayer Pieces

Sunday mornings at 8:30 in "The Gallery." Join us in prayer, fellowship, and conversation, while we knit, crochet, and cross-stitch.

Questions? Contact

Gretchen Isakson at gretchenisakson@yahoo.com
or **Robbie Giles** at robbiegiles@roadrunner.com.

J.A.M. - Jesus And Me!

for children through age 12.

Following the Children's Sermon, J.A.M. leaders will escort the kiddos down to the Fellowship Hall for crafts, games, songs, and a snack. Children will return to the Sanctuary just prior to Holy Communion.



Circle Start-Up in September!

MARY Circle usually meets the first Monday of the month. The group will meet on Monday, September 12, 2016 (the Monday following Labor Day) at 1:30 PM, at Good Samaritan Village Community Room.

Questions? Call **Shelley Dale** at 208.882.9555

or email: sdale@turbonet.com

LEAH Circle usually meets the first Tuesday of the month for devotions and a potluck lunch. All women at Emmanuel are warmly invited. The group will meet on Tuesday, September 6, 2016 at 11:30 AM. Location and Bible Study Leader TBD. Questions? **Jeanette Johnston** 208.892.9549, or **Charlene Olsson** 208.882.1028

Friends of Hospice Community Grief Support Group

will meet Tuesday Evenings, 6:30 - 8 PM, 9/6 thru 10/25 at Regency Senior Living, 2nd Floor Library, 1285 SW Center, Pullman.

This group will be facilitated by Annie Pillers (509.332.4414 griefsupport@palouse.com) and Terrie Teare. Registration in advance is greatly appreciated. Series is closed after 2nd session.

Gather with others in a small, supportive setting with care, compassion, and resources to gently explore the journey through grief.

Please note: Many of Emmanuel's Bible Study Classes and groups break through the summer.

Please watch in upcoming issues of the Emphasis: Weekly Edition and "Quick List" for when the following groups will start up again in the fall: Men's Breakfast, Adult Sunday School, Emmanuel Bells, Adult Choir, Confirmation Class.

TUESDAYS AT THE PARK! Mighty Youth and Luth Youth will meet TUESDAY, August 23, from 9:30-11:30, AT EAST CITY PARK. Contact **Lisa Allen** for questions emmanuel.luthyouth@gmail.org

CORDELIA'S FREE SUMMER CONCERT SERIES CONTINUES! Sunday, August 21 – 10th Anniversary Concert Performers from the early music series return to play at Cordelia. Dan Maher, John Elwood, Sally Burkhart, Paul Anders and others. The outdoor concert will start at 2 PM.

BREENG!!!BREENG!!!BREENG!!! Are you willing to help with CALLING some of our ELC Family to help update Member Information? We are hoping to contact everyone necessary between now and September 15. If you would help with this project, please contact **Kim Campbell** (208-310-9876) or the **Church Office** (208-882-3915). THANK YOU!!!

THE WEEDS ARE "GROWING LIKE WEEDS"... and it's a huge job keeping things looking nice and inviting here at our church home. **YOU can help? ADOPT A FLOWER BED!** The church grounds have been divided up into 12 areas all ready for a family... group... couple... individual... to adopt! Take a look on the big bulletin board in the Fellowship Hall for a map of the available plots, then **sign up!** **Let CindyMarie know which bed you would like to adopt.** Call 882-3915, email emmanuelmoscowid@gmail.com, or stop by the Church Office!

HELP NEEDED FOR FUNERAL DINNERS! The Funeral Dinner Committee is in need of workers and food donations when the need arises. Some receptions will only be cookies and coffee and some will be a luncheon consisting of salads, cookies and sandwich fixings. If you can help with one or both of these contributions as needed, please indicate on the Welcome! Card found in your bulletin, or call **Gen Long**, 877-1190 or **Gretchen Isakson** 822-7289. Thank you!

KNOW ANY ARTISTS IN OUR CONGREGATION? We need some art for The Gallery! Photos, painting, handiwork, or the like are all welcome. Contact **Kas Dumroese** (kas.dumroese@gmail.com; 208.301.2324) or the **Church Office** (emmanuelmoscowid@gmail.com; 882.3915)

EDNA HOLBROOK is in need of a caregiver willing to work 3 nights, from 11 PM - 6 AM. Please call **Rosanne Manley** at 208-659-9365 or 208-882-0616 if you would like to help with this. Thank you.

AUGUST IS SCHOOL KIT MONTH! Here's what you can bring to Change the World one week at a time! Put your items in the youth-decorated box in the bridge area. **August 21-Ball point pens (no gel ink)**
August 28-Boxes of 16 or 24 crayons

Check out the church website or ask any ME member for more info.

PASTOR'S DISCRETIONARY FUND is used by the Pastor to assist individuals and families that are in need. Most often it is used to assist people who stop by the church office and request assistance for basic needs. This is a very "hands on" ministry through our Pastor. The Pastor's Discretionary Fund is in need of your financial support. Could your support for the Pastor's Discretionary Fund be above and beyond your usual gracious giving? If you are able to, please give a separate offering ear marked for the Pastor's Discretionary Fund. Thanks for your support to this important ministry.

Pray! Praise! Congrats! Yay! Thanks!

~~~~~

*Please remember in prayer*  
those who've lost loved ones:  
**Family and friends of Rob Ramsay.**

~~~~~

Missing Rob Ramsay...

We didn't know Rob Ramsay very well but we were so glad to see him at Emmanuel on Sunday, July 31st. He sat in front of us and we hugged each other during the sharing of the peace. Recently he had been the reader, an usher and seemed so happy that he could be there again.

After the service, and before fellowship, it seemed like he wanted to embrace all that was around him. I saw him go to the baptismal font many times to make the sign of the cross. Over coffee and goodies he had a conversation with Ron Landeck about his baseball career, his surgeries, his love for Samantha and his boys and how he couldn't have gone through all of it without his faith. He also told Lisa Allen he wanted to help with the youth and take a group of kids fishing.

On our way to church the next Sunday, Cam said he thought Rob and his family would be there in the pew in front of us. Instead, it was announced that Rob had died on Thursday, August 4th. He was just 42. We are grateful for the brief time we had with Rob.

—Jeanette and Cam Johnston

~~~~~

Thank you to **Bob & Norene Bennett, Leo & Jackie Greenwalt, and CindyMarie** for adopting an Emmanuel Flower Bed!  
**9 plots are left! Adopt yours today!**

~~~~~

Happy Birthday this week to:

Scott Dockins, Ryan Perry, Macie Bakken, Elizabeth Carney, Meredith Stone, Kevin Peterson, George Paris, Vicki Jahns, Sara Martin Lawrence, Liz Brandt, Cam Johnston, Ben Kirchmeier, Olivia Halladay

Happy Anniversary this week to:

Pastor Dave & Kris Daugs
08/22/1981

~~~~~

# Serving THIS Sunday

August 21, 2016

Ministers:

The Congregation

Presiding:

Pastor Daug

Organist/Director of Music:

Janet McIntosh

Altar Guild / Bread:

Kris Daug

Acolyte:

Henry Roberts

Altar Flowers:

Matt & Kathy Foss

Assisting Minister:

Kathy Kwiatkowski

Communion Assistants:

Tara Roberts, Nancy Sasser

Counters:

Helen Joyner

Kathy Foss

Fellowship:

Bob & Nel Carver

Greg & Virginia Colvig

Nikki & Josh Cox

Kas & Deb Dumroese

Greeters:

Blake Paris

J.A.M. Leader:

Chie Barker

J.A.M. Assistant:

Deb Wyatt

Reader:

Bob Ritter

Ushers:

Vern Kinnison

Chris Watts

Paul Kwiatkowski

Verla Clauss

Richard Clauss



## CHURCH OFFICE HOURS!

The Church Office is open 8:30 AM - 4 PM, Monday - Friday. To provide this, we are in need of a few office volunteers. If you are willing to help out, please contact us! 882-3915 or [emmanuelmoscowid@gmail.com](mailto:emmanuelmoscowid@gmail.com)

## ME SELECTS PROJECTS FOR 2016 FUND DISBURSEMENT!

The Synod Assembly of 2015 authorized a Campaign for Mission as an expression of our confidence that God has called us to serve the world. These important projects have been selected by the Synod and the ELC Mission Endowment Committee.

We will vote on this list of projects for disbursement of 5% of our Endowment at the All Saint's Potluck in November:

- Completion of the Dining/Assembly Hall at Tumaini School, Tanzania
- Synod Help and Response Endowment (SHARE)
- Fund for Leaders in Mission
- Campus Ministry
- Lutheran Community Services Northwest
- The ELCA (National Campaign Support).

For more information on these projects check out the Mission Endowment page on the Church website or your see someone on the

### Mission Endowment Committee

(Carl Hunt, Charlene Olsson, Kevin Peterson, and Deb Dumroese).

---

|                         |                 |                                                                                                                                |
|-------------------------|-----------------|--------------------------------------------------------------------------------------------------------------------------------|
| <b>Wednesday Aug 17</b> | <b>6:00 AM</b>  | Weekly Publication Deadline                                                                                                    |
|                         | <b>10:00 AM</b> | Emmanuel Staff Meeting                                                                                                         |
| <b>Thursday Aug 18</b>  |                 | <i>Church Office Open Until Noon</i>                                                                                           |
| <b>Friday Aug 19</b>    |                 | <i>Church Office Closed</i>                                                                                                    |
| <b>Saturday Aug 20</b>  |                 |                                                                                                                                |
| <b>Sunday Aug 21</b>    |                 | <b><i>Fourteenth Sunday after Pentecost</i></b><br>Readings: Isaiah 58:9b-14; Psalm 103:1-8; Hebrews 12:18-29; Luke 13:10-17   |
|                         | <b>9:30 AM</b>  | Worship Service                                                                                                                |
|                         | <b>11:00 AM</b> | Fellowship (Hall)                                                                                                              |
|                         | <b>2:00 PM</b>  | Cordelia's 2016 Free Summer Concerts (Cordelia)                                                                                |
| <b>Monday Aug 22</b>    |                 | Classes begin at U of I and WSU                                                                                                |
| <b>Tuesday Aug 23</b>   | <b>9:30 AM</b>  | TUESDAYS at the PARK! (East City Park)                                                                                         |
| <b>Wednesday Aug 24</b> | <b>6:00 AM</b>  | Weekly Publication Deadline                                                                                                    |
|                         | <b>9:00 AM</b>  | ELCW Piecemakers (Hall)                                                                                                        |
|                         | <b>6:00 PM</b>  | Preschool Board Meeting (Hall)                                                                                                 |
| <b>Thursday Aug 25</b>  |                 | <i>Church Office Open Until Noon</i>                                                                                           |
|                         | <b>8:30 AM</b>  | Mtg. Office Manager & Council President                                                                                        |
| <b>Friday Aug 26</b>    |                 | <i>Church Office Closed</i>                                                                                                    |
| <b>Saturday Aug 27</b>  |                 |                                                                                                                                |
| <b>Sunday Aug 28</b>    |                 | <b><i>Fifteenth Sunday after Pentecost</i></b><br>Readings: Proverbs 25:6-7; Psalm 112; Hebrews 13:1-8, 15-16; Luke 14:1, 7-14 |
|                         | <b>9:30 AM</b>  | Worship Service                                                                                                                |
|                         | <b>11:00 AM</b> | Fellowship (Hall)                                                                                                              |
| <b>Monday Aug 29</b>    | <b>7:00 PM</b>  | Hog Heaven Band (Hall)                                                                                                         |
| <b>Tuesday Aug 30</b>   |                 | School Begins - Moscow School District                                                                                         |
| <b>Wednesday Aug 31</b> | <b>6:00 AM</b>  | Weekly Publication Deadline                                                                                                    |
| <b>Thursday Sep 1</b>   |                 |                                                                                                                                |
| <b>Friday Sep 2</b>     |                 |                                                                                                                                |
| <b>Saturday Sep 3</b>   |                 |                                                                                                                                |
| <b>Sunday Sep 4</b>     |                 | <b><i>Sixteenth Sunday after Pentecost</i></b><br>Readings: Deuteronomy 30:15-20; Psalm 1; Philemon 1-21; Luke 14:25-33        |
|                         | <b>9:30 AM</b>  | Worship Service                                                                                                                |
|                         | <b>11:00 AM</b> | Fellowship (Hall)                                                                                                              |

# Feature: Emmanuel Prayer Shawl Ministry

Remove this page. Fold it up "brochure-style," and learn all about Emmanuel's Prayer Shawl Ministry!  
Questions? Contact Gretchen Isakson (208.882.7289) or Carol Nelson (208.882.5217)

*Emmanuel  
Lutheran  
Church*

*Moscow  
Idaho*

*Our Prayer  
Shawl Ministry*



**Shawl Ministry Website:**  
[www.shawlministry.com](http://www.shawlministry.com)

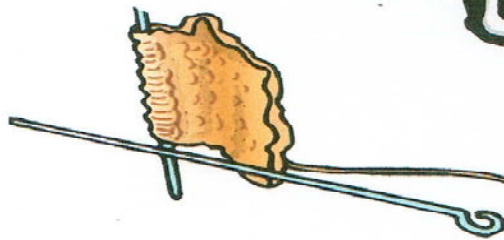

*For further information  
about Emmanuel Lutheran  
Church Prayer Shawl  
Ministry contact:  
Gretchen Isakson  
208-882-7289  
Carol Nelson  
208-882-5217*



## *Some uses for the shawl*

Undergoing medical procedures; as a comfort after a loss, during bereavement, prayer or meditation, commitment or marriage ceremonies, birthing, nursing a baby; as a bridal shower gift; leading a ritual; first menses or croning rites of passage, during an illness and recovery; ministering to others or just socializing...  
There are endless possibilities!

To make a shawl personal, the giver or the recipient may want to adorn the shawl with beads, shells, feathers and charms.

A blessing or ritual may be offered when the gift is presented.



For further information  
and to obtain instructions  
Please visit:

[www.shawlministry.com](http://www.shawlministry.com)

## About The Shawls

In 1998, Janet Bristow and Victoria Galo, two graduates of the 1997 Women's Leadership Institute at The Hartford Seminary in Hartford, Connecticut gave birth to a ministry as a result of their experience in this program of applied Feminist Spirituality under the direction of Professor Miriam Therese Winter, MMS.

Care and the love of knitting (and crochet) have been combined into a prayerful ministry that reaches out to those in need of comfort and solace. Many blessings are knitted into every shawl. The knitter begins each shawl with prayers for the recipient. Intentions are continued throughout the creation of the shawl. When the shawl is completed it is offered a final ritual before being sent along its way. As this gift has been sent along, some recipients have continued the kindness by making one themselves and passing it onto someone in need.

Thus, the blessing is rippled from person to person, with both the giver and receiver feeling the unconditional embrace of a sheltering, mothering God!

Besides knit and crochet, the shawls can be woven, sewn, quilted, machine knitted, etc.

You created every part of me,  
knitting me in my  
Mother's womb.  
For such handiwork,  
I praise you. Awesome this  
great wonder!"

Psaln 139:13-14



Shawls ... made for centuries universal and embracing,  
Symbolic of an inclusive,  
unconditionally loving, God.

They wrap, enfold,  
comfort, cover, give  
solace, mother, hug,  
shelter and beauty.

Those who have  
received these shawls  
have been uplifted and affirmed, as if given  
wings to fly above their troubles... ”

## Prayer of Blessing

May God's grace be upon this shawl...  
warming, comforting, enfolding  
and embracing.

May this mantle be a safe haven...  
a sacred place of security and well-  
being...  
sustaining and embracing in good times  
as  
well as difficult ones.

May the one who receives this shawl be  
cradled in hope, kept in joy,  
graced with peace,  
and wrapped in love.  
Blessed Be!

When you wrap yourself in this shawl,  
may you feel the loving arms of God  
wrapped around you  
and  
the loving embrace of  
all those who are praying for you.

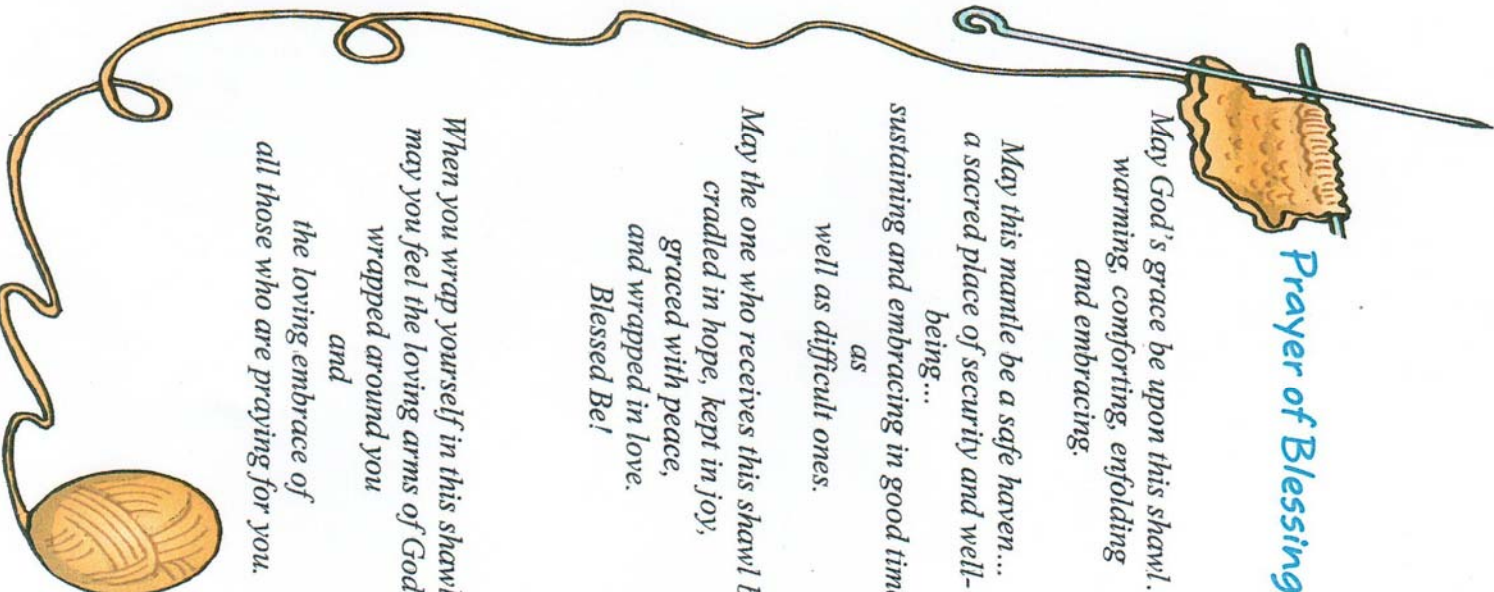

# FEATURE: Adopt a Flower Bed!

THE WEEDS ARE "GROWING LIKE WEEDS"...

...and it's a huge job keeping things looking nice and inviting here at our church home.

**YOU can help? ADOPT A FLOWER BED!**

The church grounds have been divided up into 12 areas all ready for a family... group... couple... individual... to adopt!

Take a look on the big bulletin board in the Fellowship Hall for a map of the available plots!

**Let CindyMarie know which bed you would like to adopt.**

Call 882-3915, email [emmanuelmoscowid@gmail.com](mailto:emmanuelmoscowid@gmail.com), stop by the Church Office or just mark your spot on the bulletin board!

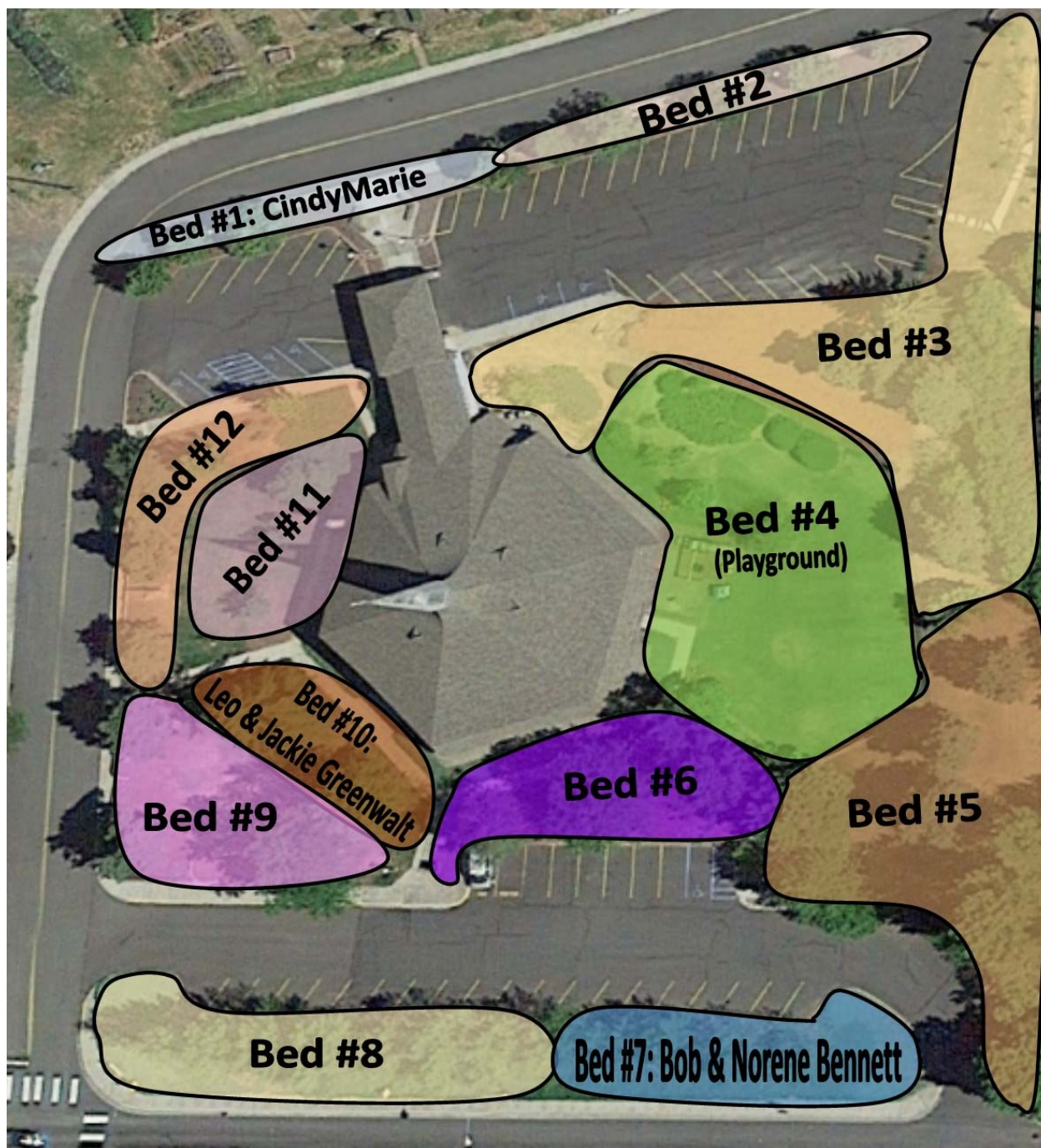

Thank you SO MUCH for helping our church home look beautiful and inviting!

# FEATURE: For the KID in ALL of US!!!

## TRUST POSTER

No matter what you face, God is with you. Make this poster as a reminder to always trust God.



### What you need:

- Cardstock
- Glue
- Twigs (a 3" piece and a 2" piece)
- Pebbles
- Black paint
- Paintbrush
- Sand or glitter
- Broken crayons (2 or 3)

### What you do:

1. On the left side of the cardstock, trace a 3"-high letter T with glue. Place twigs on the glue lines.
2. Trace an R of the same size. Place pebbles on that glue.
3. Use black paint to make a U.
4. Trace an S in glue. Pour sand (or glitter) on top.
5. Make another T with glue. Place the crayons on top.
6. After the poster dries, shake off the excess sand (or glitter) into a trash can.



## NEVER FEAR!

The Psalms are full of inspiring prayers to God, who always looks after you.

*Directions: Use the clues to fill in each missing letter. Then use those letters to complete Psalm 13:5, NIV.*

What plants grow in ..... DIR     <sub>1</sub>

The opposite of play ..... WO     K <sub>2</sub>

One-of-a-kind .....     NIQUE <sub>3</sub>

A hug and a ..... KI     S <sub>4</sub>

Sour ..... TAR     <sub>5</sub>

To speak very loudly ..... YE     L <sub>6</sub>

Immediately ..... N     W <sub>7</sub>

Bees live in a ..... HI     E <sub>8</sub>

A dandelion is this ..... W     ED <sub>9</sub>

I                     in your unfailing                 ;  
1      2      3      4      5                                  6      7      8      9  
 my heart rejoices in your salvation. Psalm 13:5, NIV

Answers: dirt, work, unique, kiss, tart, yell, now, hive, weed;  
 I trust in your unfailing love; my heart rejoices in your salvation. Psalm 13:5, NIV



# Servant SCOPE

What would **YOU**  
like to do?

*Here's an idea! Make a positive impact on  
the Sunday experience of all who enter here!*

## Serve as an USHER!

Ushering is an opportunity to serve God by serving His people, and is a marvelous way to actively and faithfully participate in the life at Emmanuel. Ushers see to it that the services flow smoothly and orderly, thus heightening the mood to receive God's Word. Ushering provides a wonderful way to begin to grow and to continue to serve in a very important role for the church. The role of the usher frequently is underestimated for its importance. Good ushers are "people-persons" who make people coming into the church feel welcome and appreciated. In doing so, ushers contribute greatly to making everyone's church experience a positive one.

In many ways, the ushers are the "face" of the church, the first ones that people see when they arrive and the last ones they see as they leave. It is important that an usher be friendly, honest, and willing to serve. It is an honorable position, requiring integrity, cordiality, and wisdom. The heart of an usher is the heart of a servant, and he does his work for his Lord Jesus ([Colossians 3:24](#)). A church usher has a true love for the people of the church and a desire to promote an atmosphere of reverence and worship in the house of God. An usher's theme verse could very well be [Psalm 84:10](#), "I would rather be a doorkeeper in the house of my God than dwell in the tents of the wicked."



**There are many ways to be involved  
in the ministries at Emmanuel.  
Just let us know what you hold interest in,  
what your gifts are, what you like to do!  
Your help is always needed and appreciated!  
Please contact us!  
208.882.3915  
emmanuelmoscowid@gmail.com**

## Serving NEXT Sunday

### August 28, 2016

Ministers:

**The Congregation**

Presiding:

**Pastor Daugs**

Organist/Director of Music:

**Janet McIntosh**

Altar Guild / Bread:

**Kris Daugs**

Acolyte:

**Jack Baker**

Altar Flowers:

**Debbie Stone**

Assisting Minister:

**Debbie Stone**

Communion Assistants:

**Deb Dumroese**

**Kas Dumroese**

Counters:

**Carolyn Todd**

**Julie Spangler**

Fellowship:

**Mat & Kathy Foss**

**Steve & Andrea Fountain**

**Robbie Giles**

**Craig & Tammy Greenwalt**

Greeters:

**Debbie Stone,**

**Nancy Ruth Peterson**

J.A.M. Leader:

**Carolyn Todd**

J.A.M. Assistant:

**Julie Spangler**

Reader:

**Barbara Taylor**

Ushers:

**Vern Kinnison**

**Kurt Queller**

**Ron Landeck**

**Walter Hesford**

**Irv Johnson**

# Meet Our Members...

## ... what Membership at Emmanuel Means...



*Emmanuel's purpose, mission, and guiding principles define our journey, and we look forward to our members participation in this ministry.*

### **Purpose Statement:**

*God's purpose for our church is to bring the light of God to all through the prism of Jesus.*

### **Guiding Principles:**



- 1. We place God above all, recognizing Jesus Christ as our Lord and Savior.*
- 2. We proclaim the gospel of Jesus Christ through words and deeds.*
- 3. We invite, welcome and value everyone as a child of God.*
- 4. We are instruments of God's love and grace, caring for and ministering to all.*
- 5. We grow in faith through prayer, worship, bible study and fellowship.*
- 6. We are responsible stewards of God's creation.*

### **Our Mission:**

*We, the body of Christ at Emmanuel Lutheran Church, proclaim the crucified and risen Christ. Our mission is to extend the Gospel of our Lord and Savior Jesus Christ through worship, outreach, fellowship, teaching, and love to God's children locally and world-wide.*

## **In this issue**

Featured in THIS issue, # 3-160821, of the "*Emphasis: Weekly Edition:*"

- 
- ∞ ELCW!
  - ∞ Emmanuel Prayer Shawl Ministry!
  - ∞ Adopt an Emmanuel Flower Bed!
  - ∞ For the KID in ALL of US!
  - ∞ "Meet Our Members..." *what Membership at Emmanuel Means...*
  - ∞ Plus our regular features:
    - "  Ed Opps"
    - "Quick List" of Emmanuel Happenings
    - "Servant SCOPE"